

AREA RIFIUTI DA DEMOLIZIONI

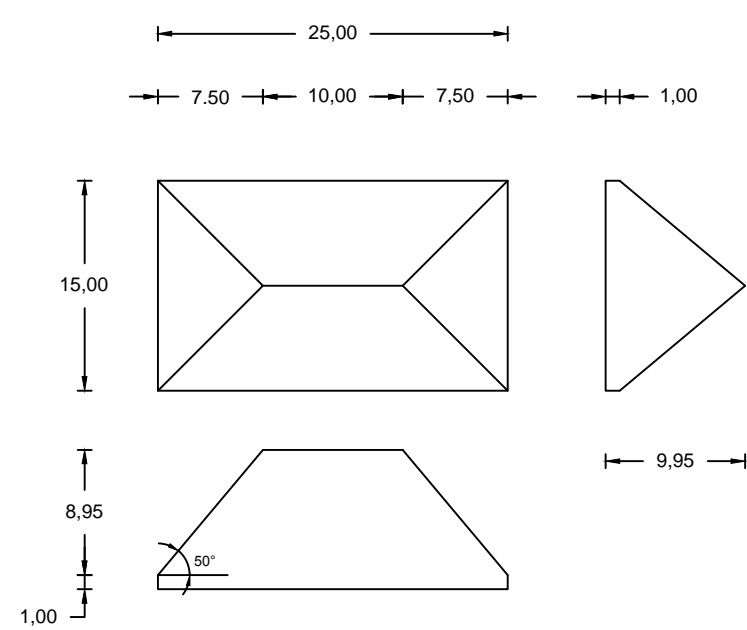

Volume = $(15.00 \times 25.00 \times 1.00) +$
 $+ ((15.00 \times 15.00) \times 8.95 / 3) +$
 $+ ((15.00 \times 8.95) / 2) \times 10.00 = 1717.00 \text{ mc}$

AREA RIFIUTI LAPIDEI

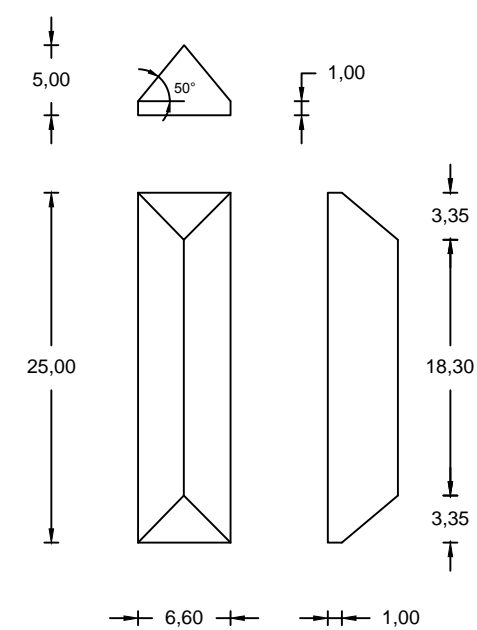

Volume = $(25.00 \times 6.60 \times 1.00) +$
 $+ ((6.70 \times 6.60) \times 4.00 / 3) +$
 $+ ((6.60 \times 4.00) / 2) \times 18.30 = 466.00 \text{ mc}$

AREA FRESATO DI ASFALTO

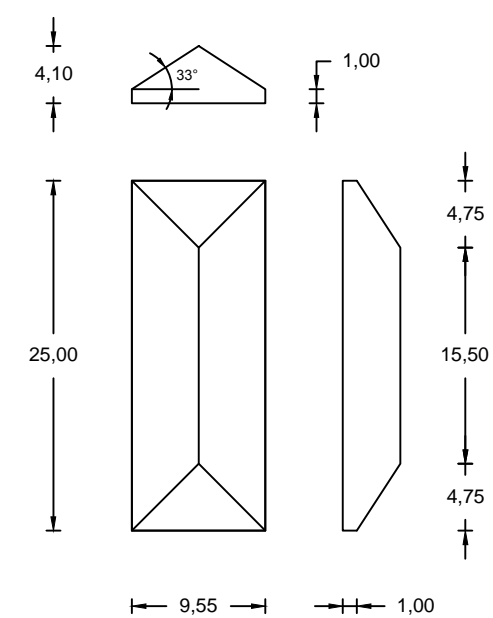

Volume = $(25.00 \times 9.55 \times 1.00) +$
 $+ ((9.50 \times 9.55) \times 3.10 / 3) +$
 $+ ((9.55 \times 3.10) / 2) \times 15.50 = 562.00 \text{ mc}$

AREA TERRE E ROCCE DA SCAVO

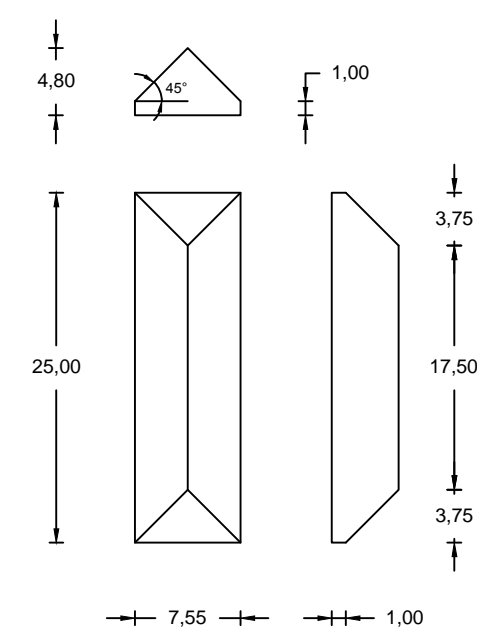

Volume = $(25.00 \times 7.55 \times 1.00) +$
 $+ ((7.50 \times 7.55) \times 3.80 / 3) +$
 $+ ((7.55 \times 3.80) / 2) \times 17.50 = 512.00 \text{ mc}$